



## Preserving The Public Land Survey System

Ensuring that Minnesota's Public Land Survey System (PLSS) Monuments are available for everyone

Public Land Survey System Monuments are essential for all property descriptions, location of infrastructure, and are the basis for accurate digital geospatial data.

# The Public Land Survey System is?

- Legal & geographic framework covering 2/3 of the USA
  - Underpins the land tenure system in the PLSS states
    - Basis for all property descriptions
    - Enables the secure transfer of property
  - Describes the land and where it's at on the earth
    - GIS data and mapping is directly related to the framework
      - Municipalities, parcels, roads, zoning, online maps, ad infinitum

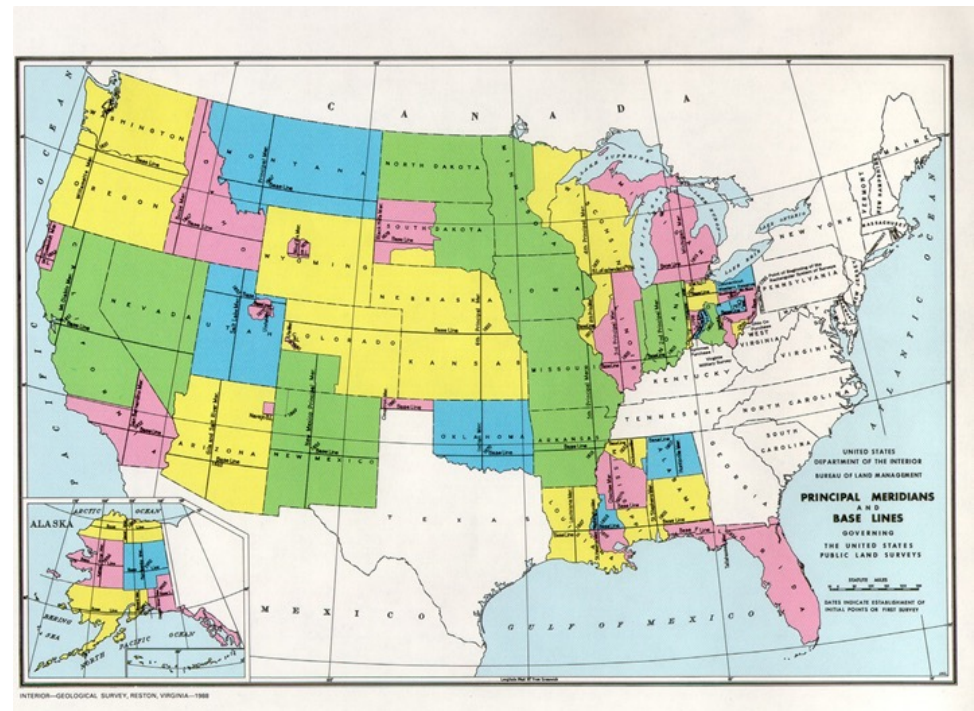

Set posts for corner to Sec. 20, 21, 28 and 29  
Black Oak 8 S 52 1/2 to 45-1/2  
Black Oak 6 N 32 W 19 links  
Black Oak 9 S 35 W 18 links  
Black Oak 7 S 40 W to 27 links  
Surface  
L.S.

# Following in the footsteps

- Evidence of the PLSS is supported by monuments
  - The original monuments in the ground, by law, define the PLSS
  - They were, and continue to be, used to further subdivide property

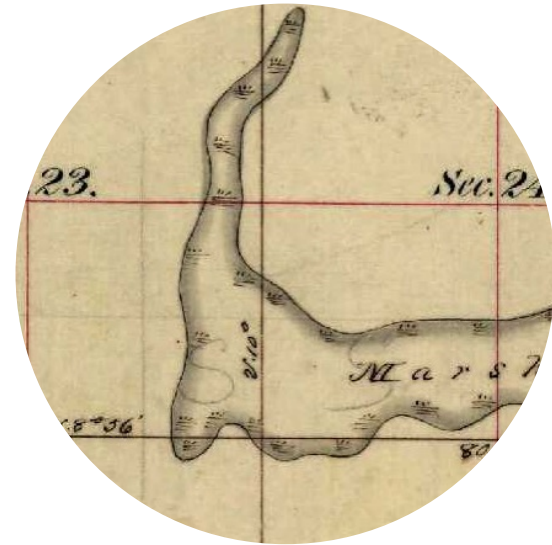

# The current state of PLSS monuments

- 325,000 + PLSS Monuments set in MN
- Feds gave authority to the states who gave that to the counties.
- Less than ½ of the monuments (150,000) have a known location
- In 1896 Ramsey County recognized the need and began remonumentation. 30% still in place.

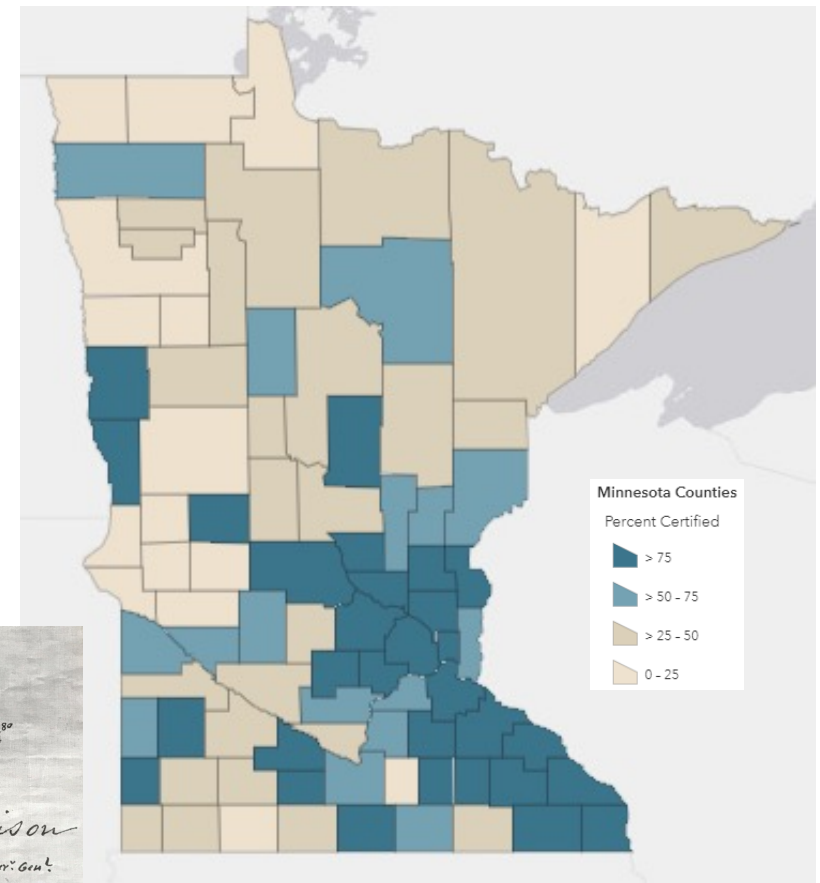
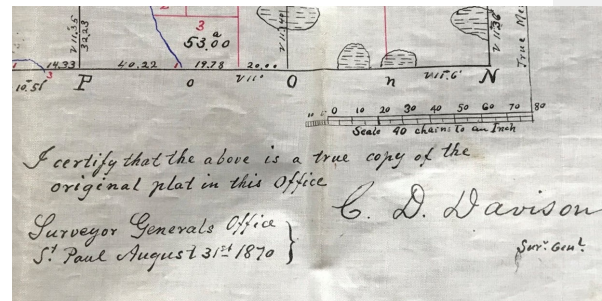

# The Solution(s)

- Having a methodical program to preserve the future by perpetuating the PLSS
- Over 165,000 unknown monuments must be found and locked into the digital system.
- Cost is approximately \$1,800 per monument.
- Cannot be done in 1 year.

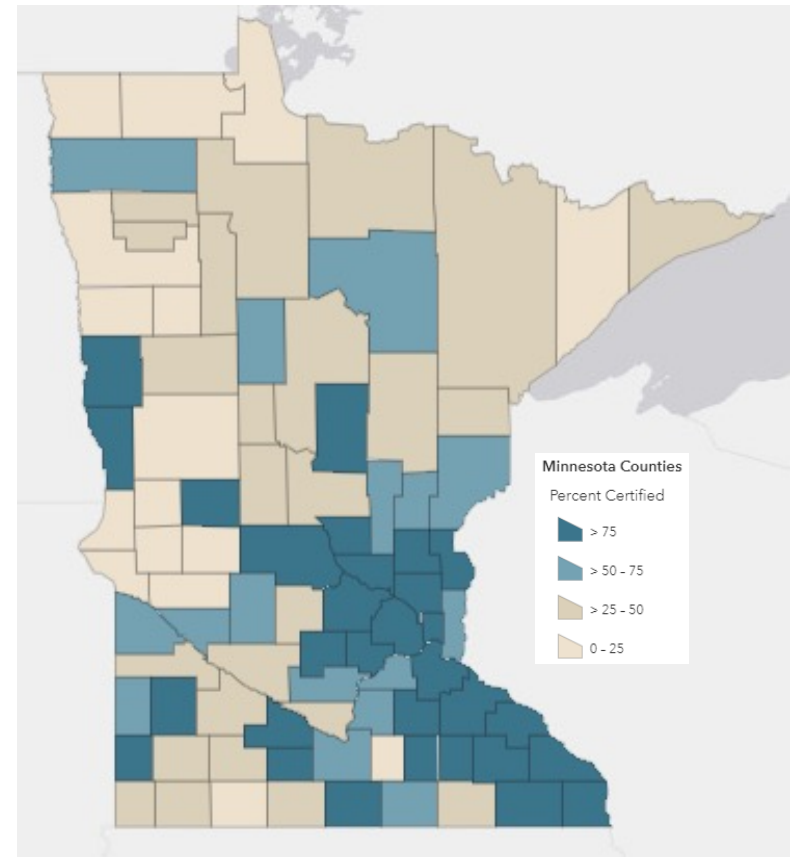

# Benefits of preserving the PLSS

- Enable the secure transfer of property
- Reduce ambiguities in the land tenure system
- Accurate location and cost savings for projects
- Creates secure land records for future generations, minimizing future lawsuits (\$15,000 minimum cost per party)
  - Deterioration of the PLSS = Disputes
- More precise data creates informed records for land management, and accurate taxation
- Brings Minnesota into the modern era of land management
- Provides high paying jobs (\$60– 130 k)

# Supporters



# Summary - PLSS

- The PLSS land survey system predates the state of Minnesota and is integral to our property management system.
- 150 years of neglect has taken its toll and flaws are becoming worse.
- We must take this crucial infrastructure into the digital age.
  - Introduce by Rep. Mike Freiberg (DFL-Golden Valley) in the House (HF1231),
  - Introduced by Sen. Jim Carlson (DFL-Eagan) in the Senate (SF1659)
- Bi-partisan support
- Cost \$300 million over 30 years (\$10 million per year)
- Wisconsin currently spending \$13 million on land records and PLSS monument modernization.