

Minnesota Department of Public Safety



m MINNESOTA

Minnesota Department of Public Safety



Capital Budget Requests 2020

1. State Emergency Operations Center | \$29.5M
2. Southern Minnesota BCA Regional Office and Laboratory | \$125K
3. BCA Maryland Building Improvements | \$3.6M
4. Regional Training Facility Study | \$500K



State Emergency Operations Center

Commissioner John Harrington

State Emergency Operations Center



- **The State's Emergency Operations Center is a one-of-a-kind, "no fail" facility.**
- **Current facility concerns**
 - HSEM is located in leased space in the Town Square complex.
 - \$525,000 year for a substandard facility.
 - Mixed-use, densely-developed area.
 - Undersized space - 22,000 square feet.
 - Lack of redundancy for operations.
 - Access control and security.



State Emergency Operations Center



- **\$29.545 million - Property purchase, site development and construction.**
- **Site Selection Criteria**
 - 10-15 miles from State Capitol complex.
 - Access control and security control to protect critical operations.
 - Located away from known risk and hazard areas.

Request Details - \$29.545M

Purchase commercial lot in Blaine	\$1.0 million
Design and pre-construction services	\$2.6 million
Site preparation	\$1.0 million
Standard office building	\$12.0 million
Security and redundancy	\$3.0 million
Information technology	\$4.2 million
Furniture, fixtures, and equipment	\$1.9 million
Occupancy	\$.3 million
Inflation factor	\$3.545 million

State Emergency Operations Center



Meeting Strategic Priorities

- Improves our ability to provide a range of DPS programs.
- Fills a critical need to have a modern and reliable SEOC.
- Provides Continuity of Government (COG) facility.
- Ensures state assistance will be available to local communities.
- New building will meet or exceed state sustainability requirement.



Southern Minnesota BCA Regional Office and Laboratory

Drew Evans, Superintendent BCA

Southern Minnesota BCA Regional Office and Laboratory



Forensic evidence testing is increasing.

- Evidence submissions for DNA analysis have increased by 120% since 2009.
- Controlled substance submissions have nearly doubled over the last five years.
- Digital media evidence analysis has nearly doubled from 2017 to 2018.

An additional facility to meet the needs of criminal justice partners.

- Better provide services to local law enforcement.
- Providing investigative and laboratory services in Southern Minnesota.
- Eliminating the need to transfer items to BCA Headquarters in Saint Paul.

Southern Minnesota BCA Regional Office and Laboratory



\$125,000 - Pre-Design – Southern Minnesota Regional Office

- Laboratory and Investigations.
- Approximately 40,000 square foot building.
- Planning for current and future needs to meet demands for service.
- No additional lab space available at BCA Headquarters.
- Better service delivery and address increased demands for services in greater Minnesota.

Regional Office Services

Laboratory Services

Evidence Intake / Processing

Biology

Drug Chemistry

Latent Prints

Firearms and Toolmarks

Crime Scene

Digital and Multimedia

Investigative Services

Homicide – Violent Crimes

Missing Persons

Predatory Crimes

- Human Trafficking
- Online Child Exploitation

Financial Crimes

Narcotics Trafficking

Crime Scene

Digital and Multimedia

Regional Office - Bemidji





BCA Headquarters Improvements

Drew Evans, Superintendent BCA

BCA Headquarters Improvements



Imminent Facility Needs

- Moved to location in 2003.
- 225,000 square foot building.
- Safety and security paramount to operations.
- No additional space available at BCA Headquarters.
- Onsite buildout is ideal for security, energy efficiencies, waste reduction, and overall security of operations and staff.



BCA Headquarters Improvements



\$3.6 Million - BCA Headquarters Improvements

- Enhancements to perimeter security.
- Finish space to house employees.
- Build out finishes remaining 7,600 of unfished square feet.
- Add perimeter fence on 3 sides of building for added security.

BCA Headquarters Improvements



Minnesota
BCA
Bureau of Criminal Apprehension

Buildout Unfinished Space

- 44 work stations.
- Utilizes existing BCA space.
- Mix of office and cubicle space.
- Maintains collaborative access for partners co-located within space.

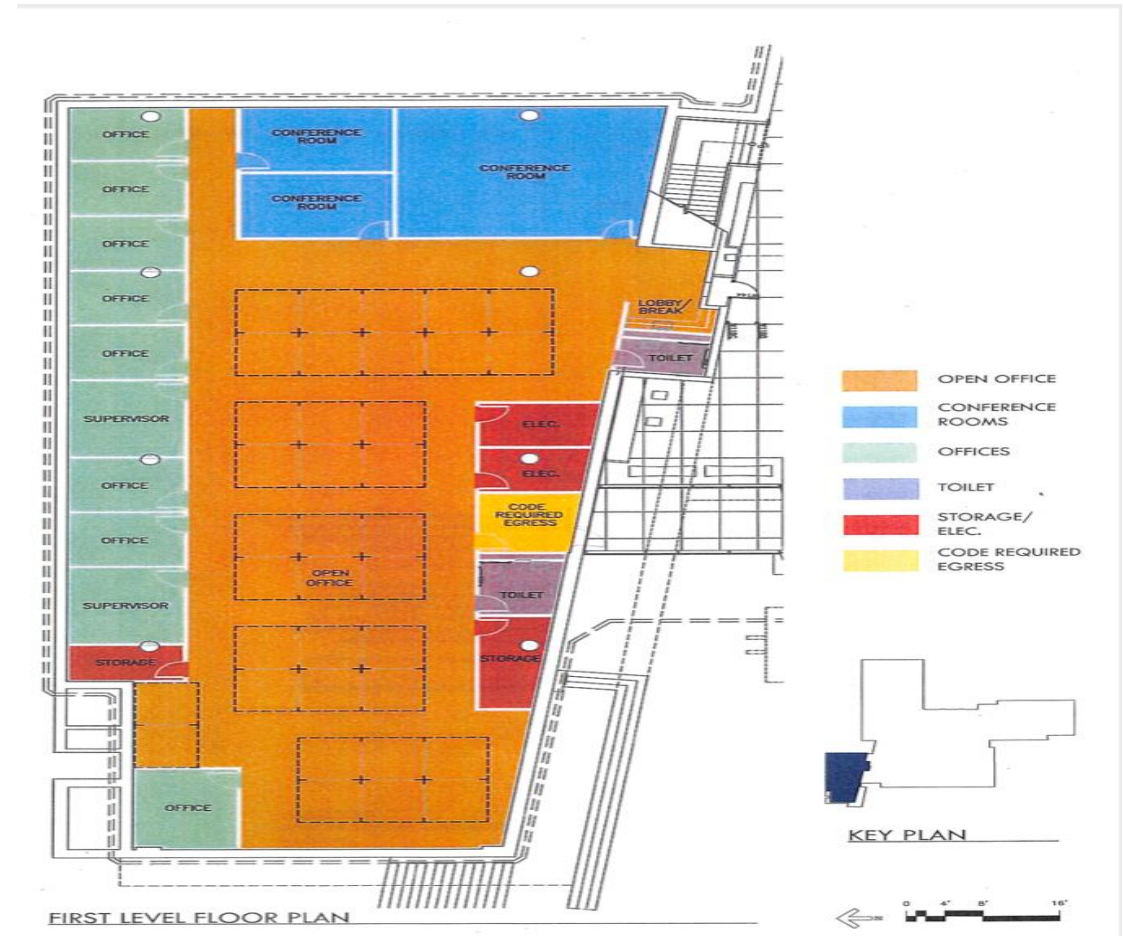

BCA Maryland Building Improvements



Perimeter Fence

- Security assessment by U.S. Dept. of Homeland Security.
- Building houses critical systems, evidence, employees performing sensitive work and the visiting public.

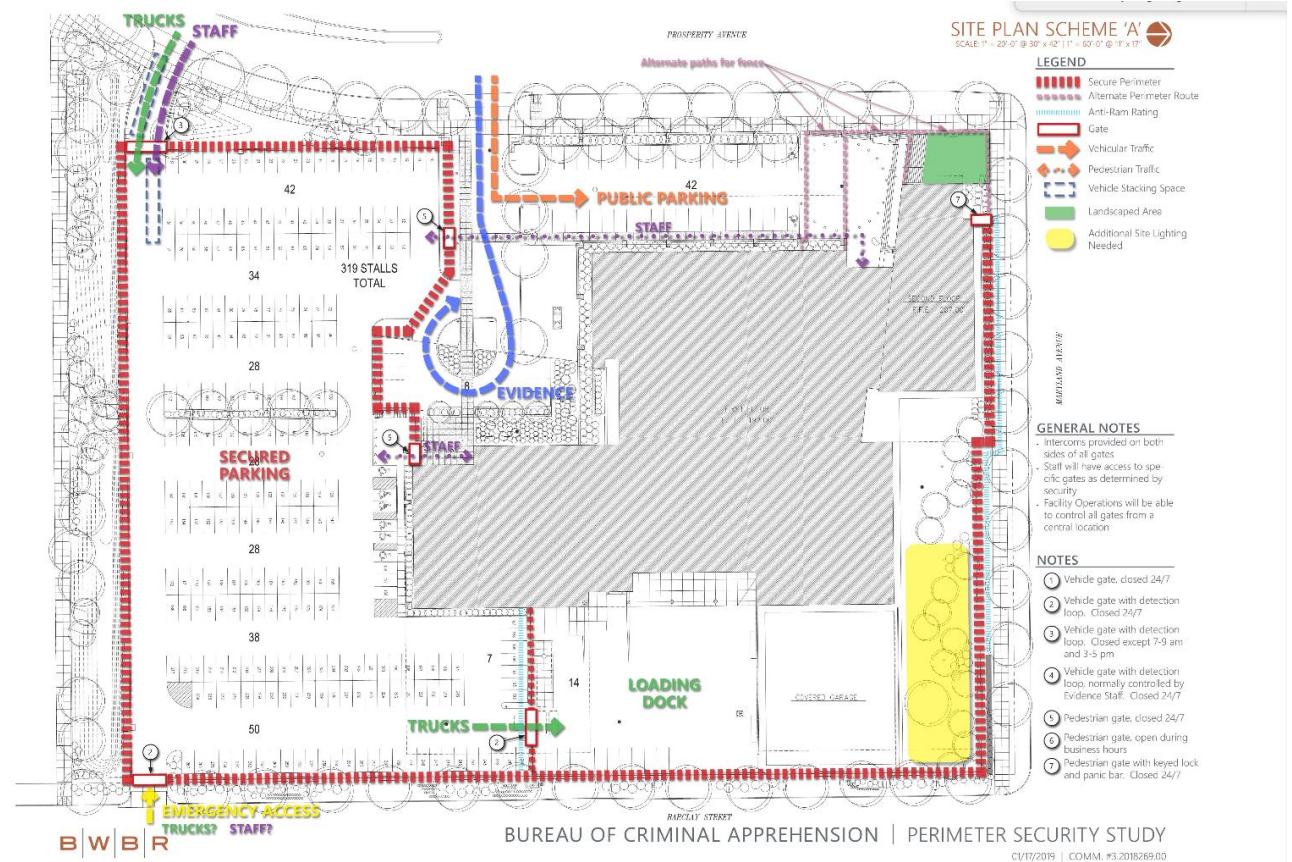



REGIONAL TRAINING FACILITY STUDY

Commissioner John Harrington

Regional Training Facility Study

\$500,000 - General Fund Cash

- Needs assessment to evaluate training facilities for fire, police, and emergency response personnel across the state.
- The assessment will review facility locations, training delivery methods, and operating costs.



Questions?

John Harrington, Commissioner
651-201-7174
John.M.Harrington@state.mn.us