



MINNESOTA AMATEUR SPORTS COMMISSION

2012 Capital Bonding Request

#1	NW Regional Sports Center – Moorhead	\$4,000,000
#2	SW Regional Sports Center – Marshall	\$4,000,000
#3	NSC Field Development – Blaine	\$ 400,000
#4	National Youth Baseball Center – Blaine	\$5,600,000
#5	Urban Regional Sports Center– St. Paul	\$ 100,000
#6	Asset Preservation – NSC HVAC Replacement	\$ 375,000



MASC ANNUAL ECONOMIC IMPACT (OUT-OF-STATE)

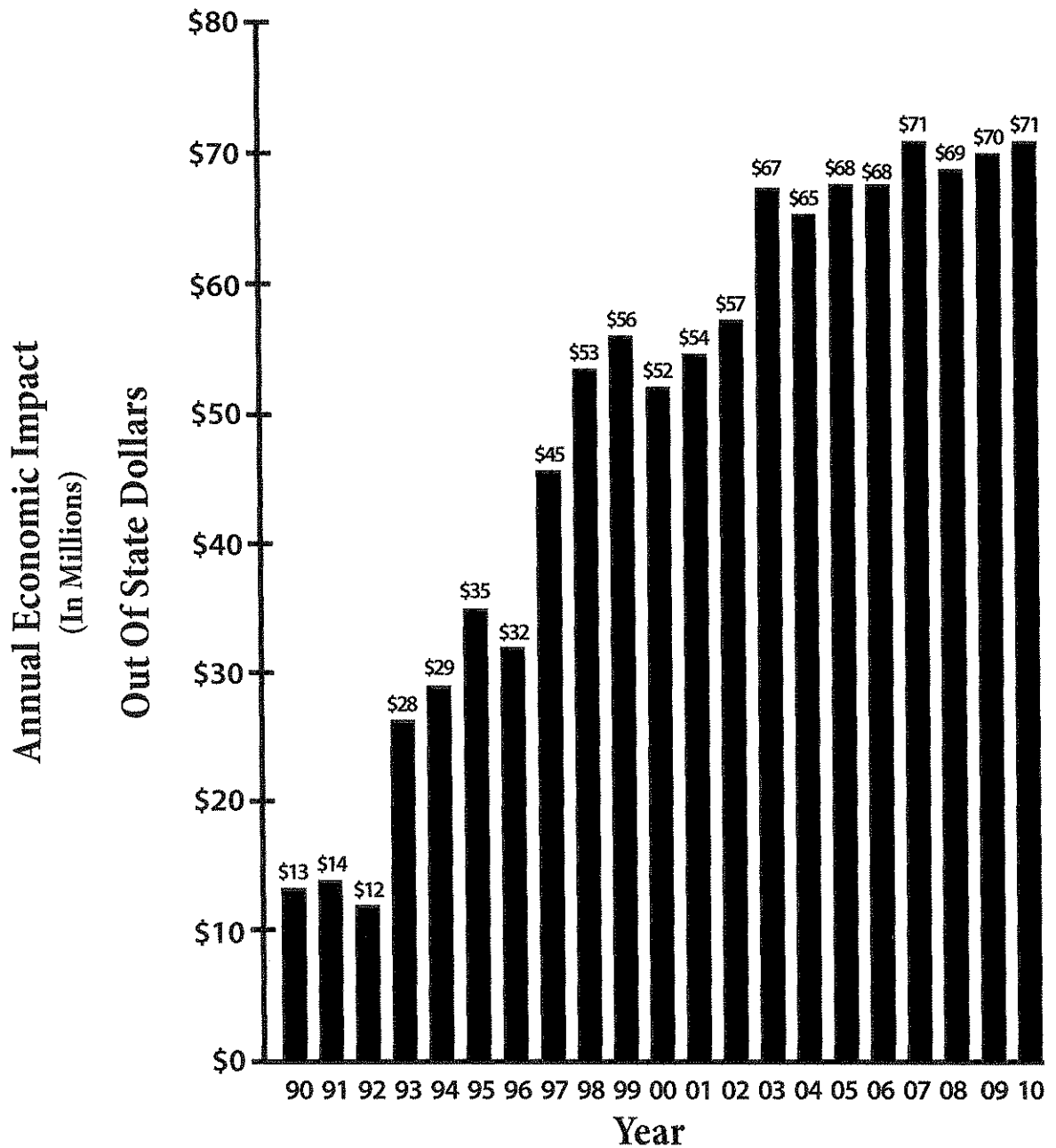



MINNESOTA'S RETURN ON INVESTMENT AMATEUR SPORTS

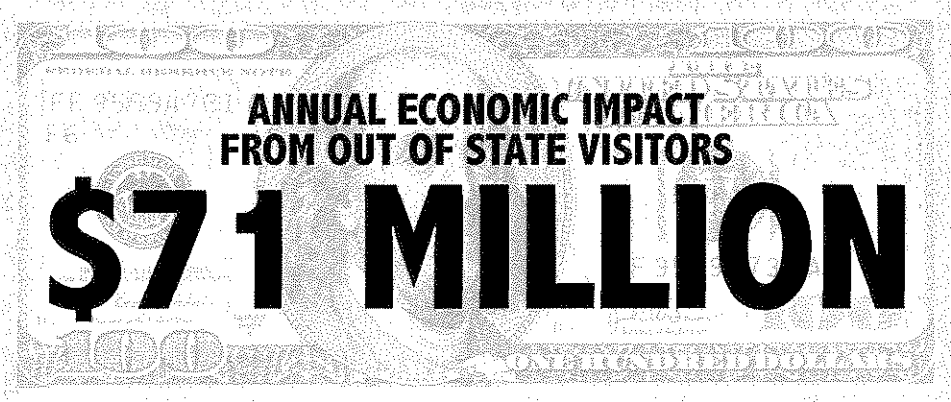

**\$5 MILLION
IN SALES TAX**

Annual State Investment

\$3.8 Million Annual Principal and Interest
on \$50 Million in Bonds



- National Sports Center, Blaine
- University of Minnesota Aquatic Center, Minneapolis
- National Hockey Center, St. Cloud
- Giants Ridge Golf & Ski Resort, Biwabik
- National Whitewater/Kayak Center, Carlton
- Ole Mangseth Memorial Ski Jump, Coleraine
- John Rose Minnesota OVAL, Roseville
- National Volleyball Center, Rochester
- Range Recreation Civic Center, Eveleth
- Minneapolis Sports Center, Minneapolis
- Bush Lake Ski Jump, Bloomington

**\$3.8 MILLION
COST TO STATE**



**\$1.2 MILLION
SURPLUS TO STATE**



STATEWIDE AMATEUR SPORT FACILITIES

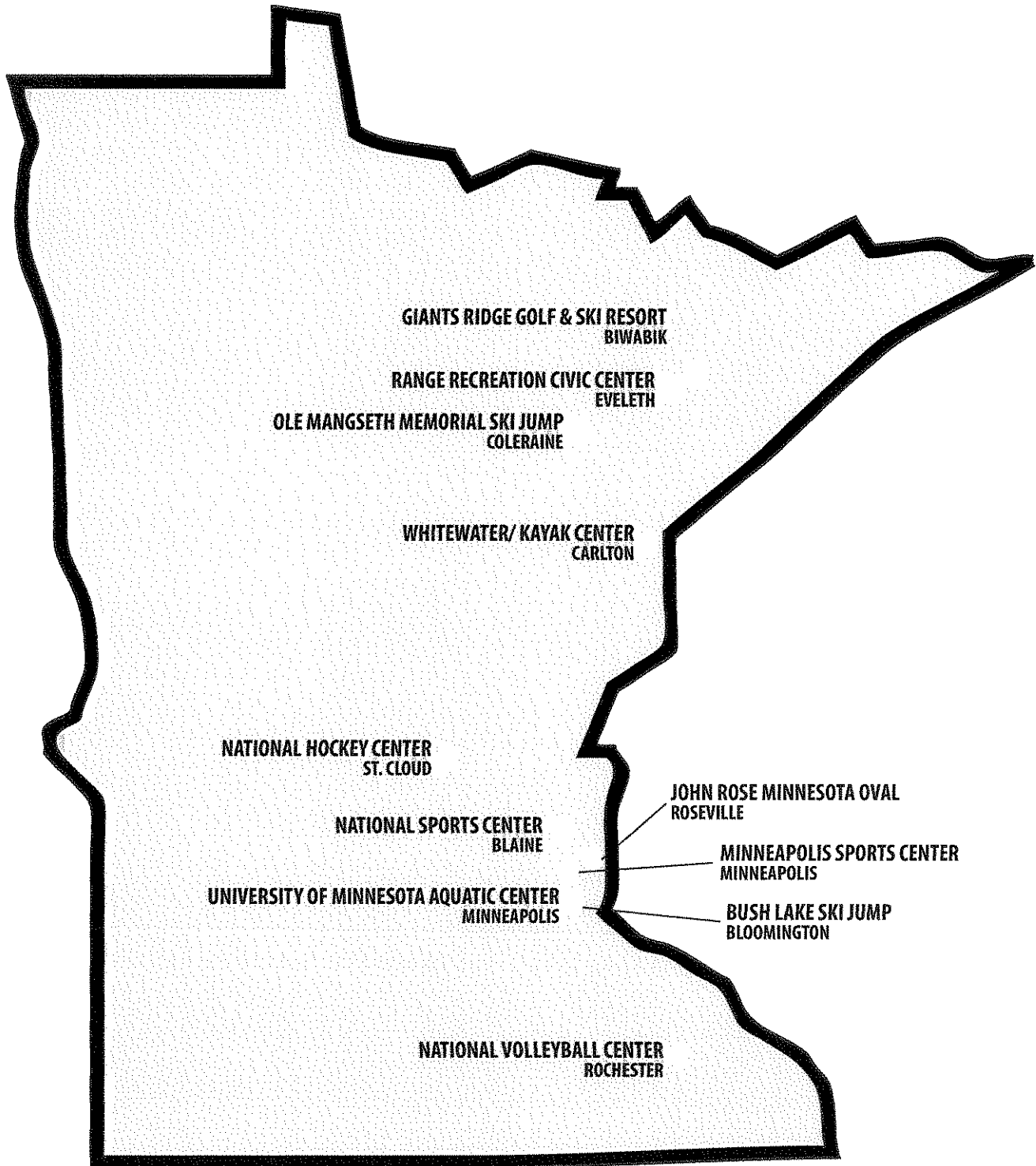

Five Million Annual Visitors



Statewide Master Plan

Regional Amateur Sports Centers

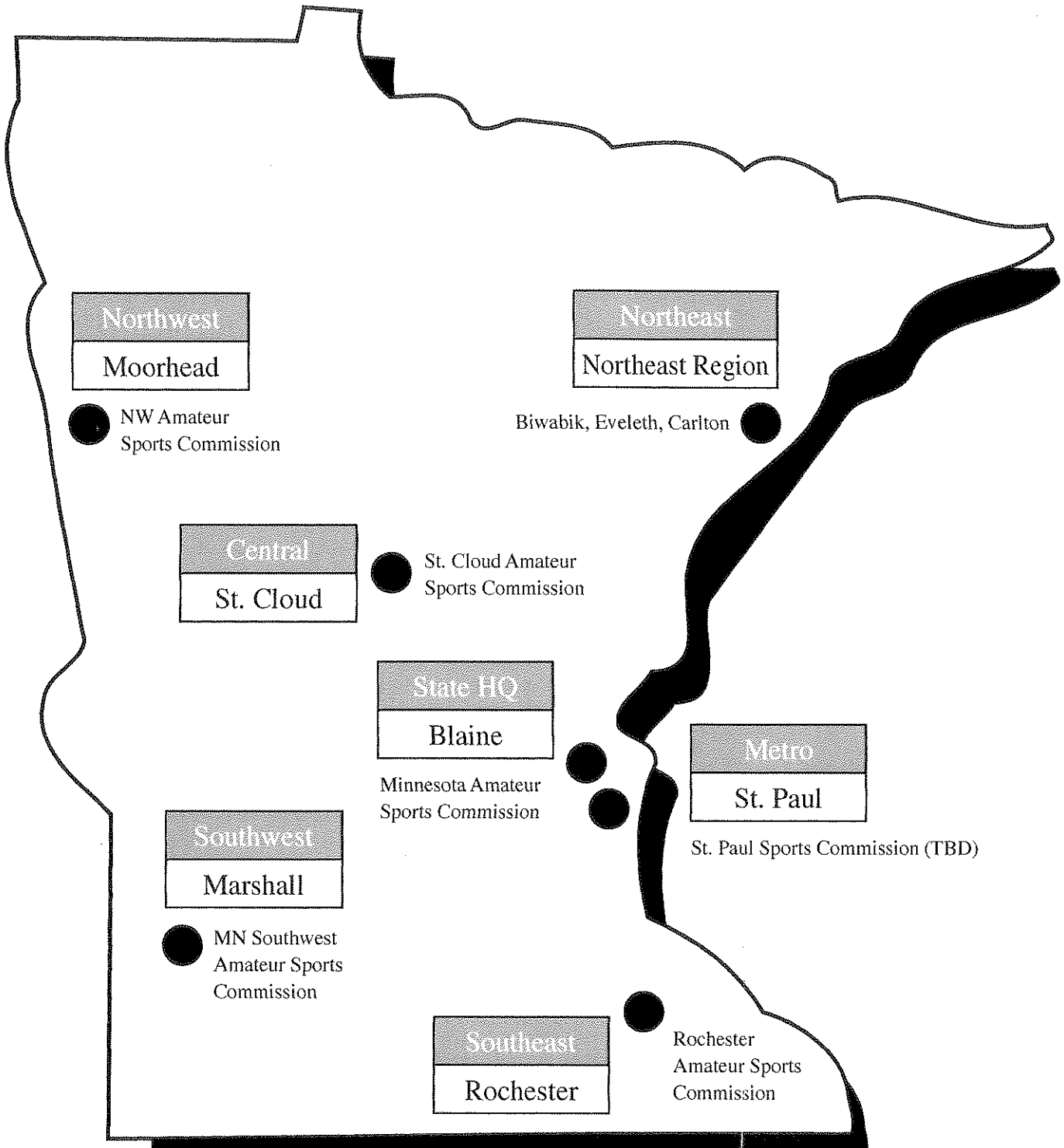



Regional Amateur Sports Centers

Key Elements

- Sports Facilities
 - State of the art
 - Critical mass of fields or courts
 - State university, city, school district facilities

- Hospitality Infrastructure
 - Hotels
 - Restaurants

- Tourism Amenities
 - Shopping
 - Museums
 - Local attractions

- Regional Sports Commission
 - History of hosting events
 - Staff and resources to create and bid for events

Minnesota Northwest Regional Amateur Sports Center Capital Cost

Acquisition	\$ 1,300,000	
Municipal Infrastructure	\$ 3,500,000	
Site Improvements		
• Phase 1	\$ 2,650,000	
O Completed		
O Athletic Field Development Part I		
• Phase 2A+2B	\$ 2,025,000	
O Completed		
O Internal Drives and Trails		
O Administrative/Concession/Bathroom Facilities		
O Miracle Field		
• Phase 3 (2012)	\$ 4,000,000	
O 2 Championship Fields		
O Parking Lot Lighting & Expansion		
O Additional Field Development (synthetic turf optional)		
O Maintenance Building		
• Phase 4	\$ 1,200,000	
O Neighborhood Park Amenities		
Total Cost	\$14,675,000	100%
City Match Contribution	\$10,675,000	73%
State of MN - MASC Grant	\$ 4,000,000	27%

Figure 4

National Youth Baseball Center

World's Largest Youth Baseball Complex

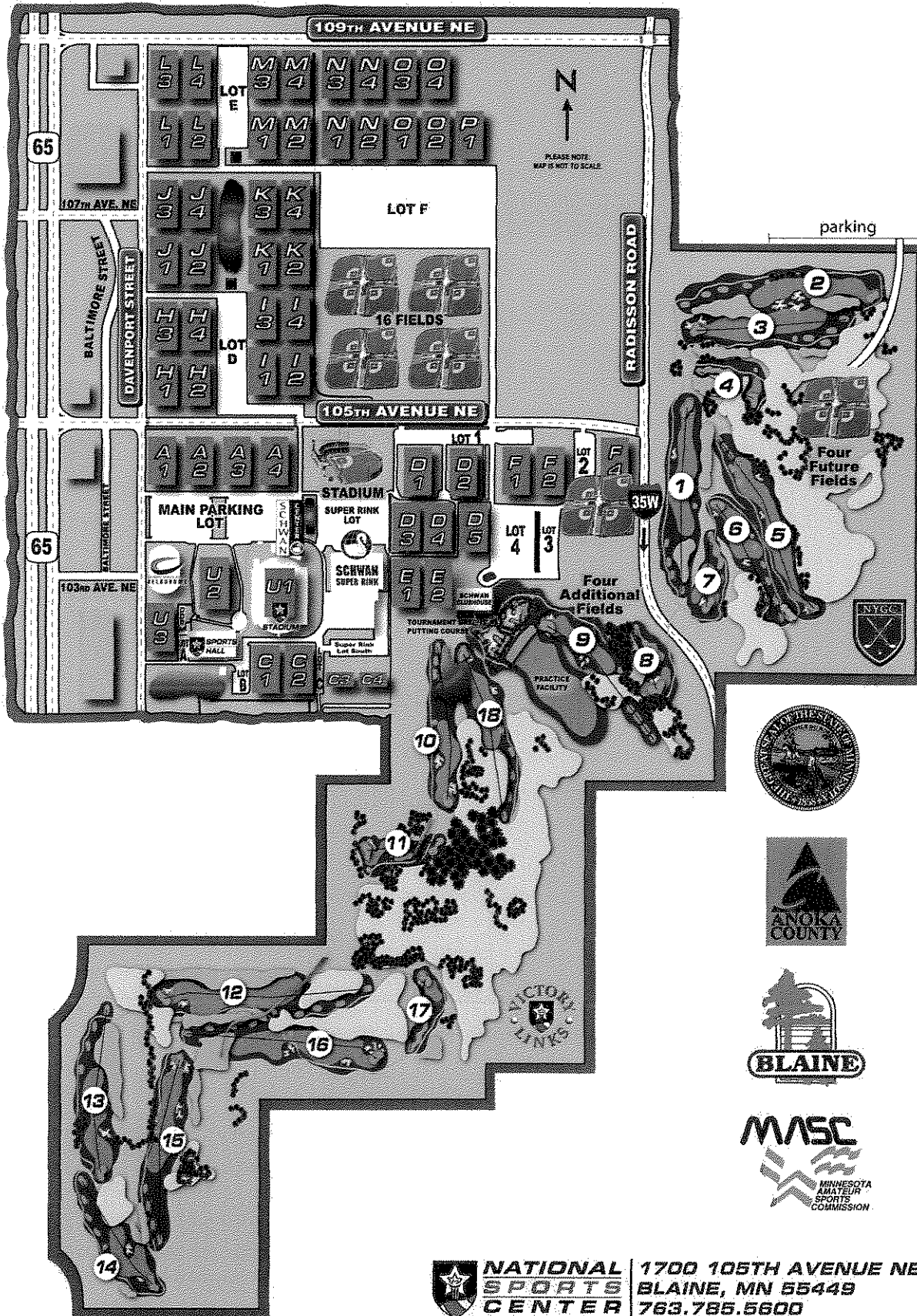

NATIONAL SPORTS CENTER | 1700 105TH AVENUE NE
 BLAINE, MN 55449
 763.785.5600

Victoria Park

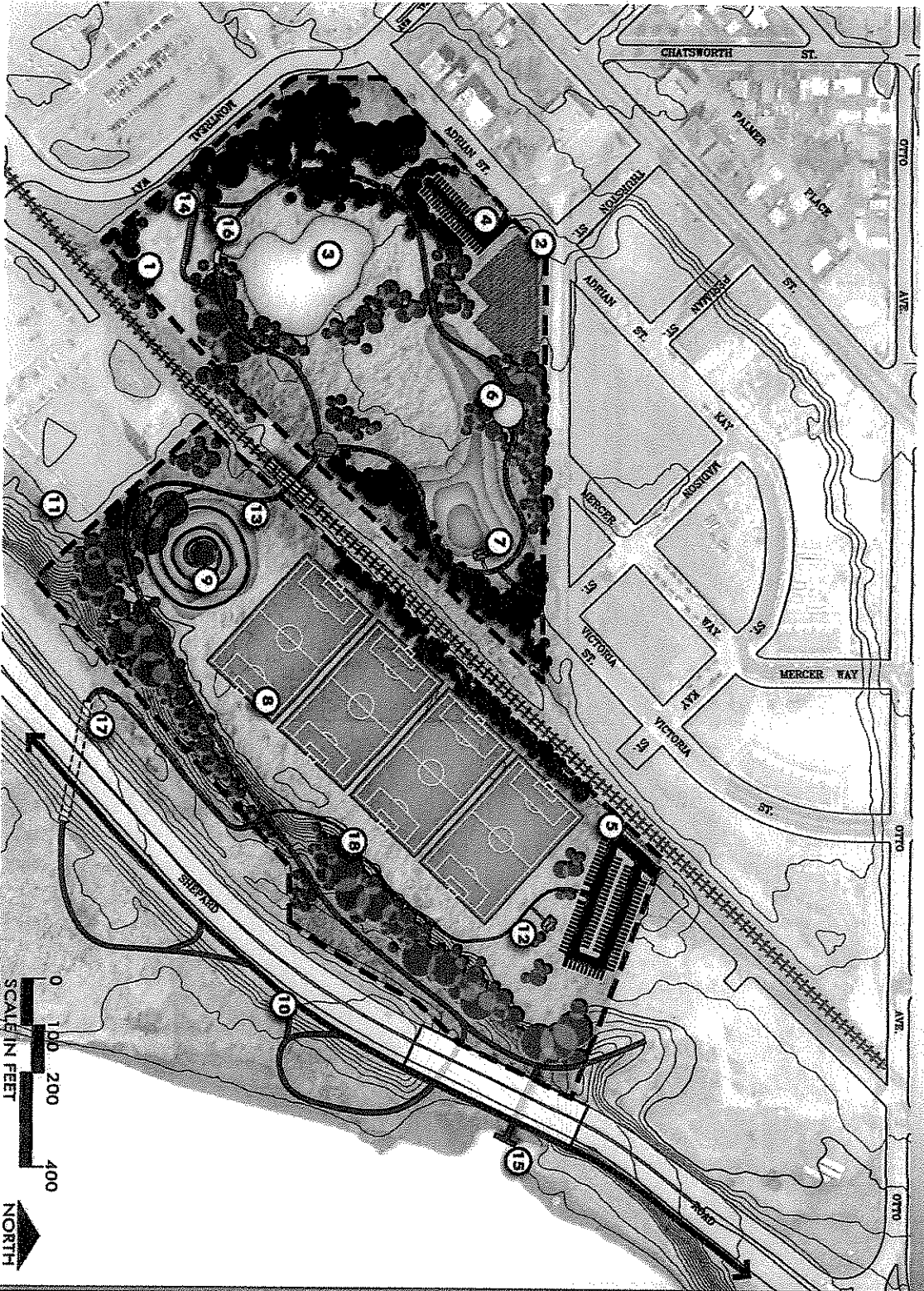

VICTORIA PARK CONCEPT PLAN

SCHEDULE

- TOTAL PARK AREA - 34.5 ac
- NEIGHBORHOOD PARK AREA - 15.2 ac
- SOCCER FIELDS - 5.9 ac
- EXISTING WETLAND - 1.2 ac
- WATER FEATURE (AS SHOWN) - 1 ac
- COMMUNITY GARDEN - .5 ac
- BLUFF AREA - 5.1 ac

LEGEND

- 1 EXISTING WETLAND
- 2 COMMUNITY GARDENS
- 3 POND/WATER FEATURE
- 4 PARKING
- 5 TRUCK VEHICLE SOCCER PARKING
- 6 PLAY AREA
- 7 PICNIC SHELTER/RESTROOMS
- 8 SOCCER
- 9 PATRICK'S OVERLOOK MOUND
- 10 EXISTING SHEPARD ROAD/PEDESTRIAN BIKE TRAIL
- 11 EDGE OF BLUFF
- 12 CONCESSIONS/RESTROOMS
- 13 BIKE/PEDESTRIAN/SKI TRAIL
- 14 WETLAND BOARDWALK
- 15 NON-MOTORIZED BOAT LANDING
- 16 PEDESTRIAN BRIDGE
- 17 ADD. TRAIL THROUGH EXISTING TERNIE
- 18 PEDESTRIAN TRAIL CONTACT