

HF 587 represents a vision of a place like no other in the world, bringing people from throughout the world to Minnesota

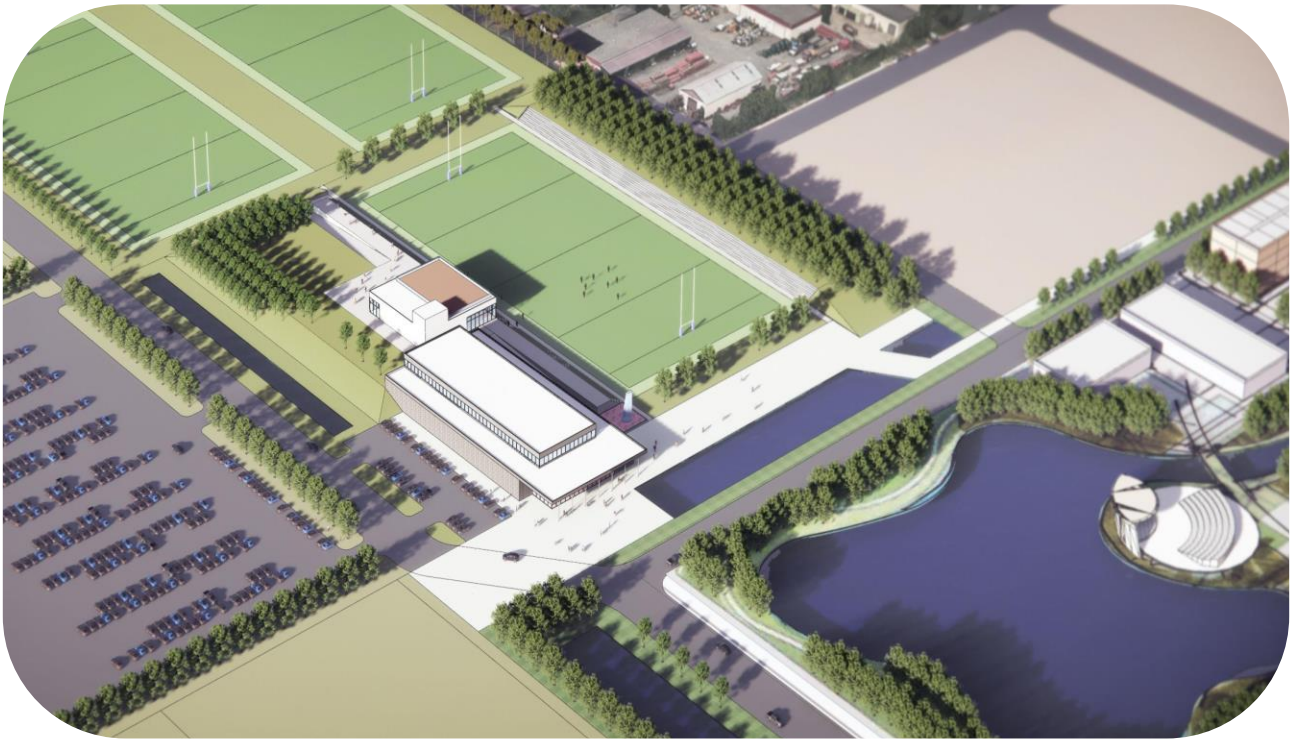

The first barrier-free experience designed for athletes of ALL abilities, including caregivers, families, and fans



Rugby Unified  
HF 587 National Rugby Center



Rugby and Wheelchair Rugby are played across 123 countries and attract players of every size, ability, and gender representing diverse communities bound together by their passion for this sport.

This is the foundation for this barrier-free experience to serve the under-served sports of Power Hockey, Wheelchair Basketball, Power Soccer, Paralympic Volleyball and more.

## Significant Social Impact

The first athletic facility designed from the ground to be barrier-free for adaptive athletes, caregivers, families and fans. Programming for multiple sports that promote independence, community engagement, well being and quality of life.

## A Money Maker

The \$6 Million (minimum) annual economic impact leverages the programming capabilities of the National Sports Center. There is significant opportunity to increase the impact.

Annually self funding including maintenance.

## An Opportunity

This Vision and Plan provides Minnesota the opportunity to demonstrate how social and economic impacts can compliment one another.

## How We Got Here

We began this journey over 3 years ago when the National Sports Center asked us to “think big” about the opportunity on their campus. This vision and plan deliver that in an exciting and realistic way.

We are Rugby Unified, a 501(c)(3) non-profit with 25 years of experience partnering to create and manage a public athletic facility.

## The Plan and Cost

- Maximum size outdoor rugby pitches (2 grass, 1 turf) with infrastructure & seating to support all levels of play - \$2.5M
- Integrated complex of 16,000 sq ft designed for adaptive and non adaptive athletes, caregivers, families, and fans - \$10.0M
- Indoor wheelchair rugby courts over 37,000 sq ft for a multitude of adaptive sports - \$19.2M

## Our Invitation to You

Our initial discovery has included all aspects of play, from adaptive and non-adaptive athletes, caregivers, families and fans. This has included reaching out to Veterans organizations such as the National Veterans Wheelchair Games and the VA Adaptive Sports & Arts. However, our journey to discover all that will make this a barrier-free experience has only started.

Athletic venues to date have been designed to incorporate the minimum standards of laws such as Americans with Disabilities Act (ADA), and some venues have gone beyond those minimum standards to modify existing facilities.

*A barrier-free athletic facility design has never been pursued from the ground up. A barrier-free environment will allow for free and safe movement, function and access for all, regardless of age, sex or condition. All will access, **without obstacles**, with dignity and with as much independence as possible. Barrier-free design means equal opportunities, participation and access to and through design for all people. It also includes future-oriented, inclusive and adaptable designs.*

We seek your input and support, and all others, as we present this vision. Inclusivity is hard, as are most great ideas. We welcome all points of views to build this vision for Minnesota.

## Rugby Unified

Duane Arens  
Chris Babiash  
Jason Booth  
Aaron Britt  
Joe Delagrave  
Adam Dilley  
Barb Fugate  
Joe Kiley  
Tom Osdoba

Bob Ewert (BKV Architects)