



EXPANDING THE SAFETY AND WELLBEING OF MINNESOTA'S CHILDREN



Who is CornerHouse?

CornerHouse is a nationally-accredited Children's Advocacy Center with a 30+ year history of creating and training on evidence-based practices. We are a successful example of partnering with child protection, county agencies, and law enforcement to provide a collaborative response for children who disclose abuse. CornerHouse is a trauma-informed center focused on identifying, intervening, and interrupting the cycle of violence. We focus on improving safety and stability and reducing trauma so children and families can thrive.

15,000+
children
served

Evidence-Based Response Protocol

- Families supported by CornerHouse are much less likely to have a recurring incident of maltreatment
- Children's trauma symptoms are identified, escalated as needed, and addressed with ongoing family support and specialized mental health services
- Parents have the knowledge and skills they need to provide a safe and supportive home
- Children have increased school success and educational attainment
- Adolescents successfully enter the workforce
- Future improvement of public health and safety for our community

33,000+
professionals
trained

Nationally-Recognized Training Program

We are a globally-recognized expert training organization with over 30 years of experience pioneering a continuum of best practices in interviewing children and vulnerable adults.

Funding Request - Infrastructure Support

\$1,177,500 will provide:

- Infrastructure support needed to expand children and family services to 3,000 additional children
- Expand our geographic reach
- Provide the platform for prevention and mental health services in both rural and urban Minnesota

Project Budget

Architect	\$96,449
Low Voltage, Sound Masking, AV, Security	\$301,000
Furniture, Fixtures, & Equipment	\$450,000
Construction	\$1,646,991
Total Project Budget	\$2,516,940
Total Project Secured Contributions	\$1,316,940
Total State Ask	\$1,177,500

An investment of
\$400
per child



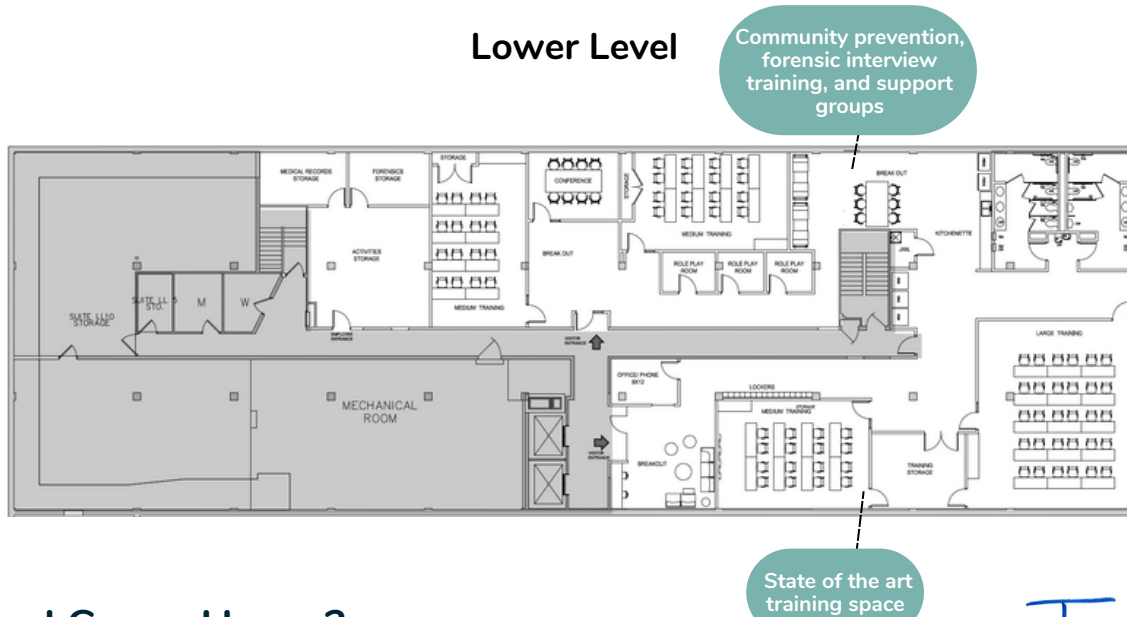

Why fund CornerHouse?

Our comprehensive and nationally-accredited services are the solution to improve the wellbeing of children, help parents provide safer and more supportive homes, and prevent families from re-entering child protection.



Contact Us



Mitzi Hobot, MPA, MBA
 Executive Director
 651-403-0778
mitzi@cornerhousemn.org

Michael Mollner
 Christopherson Advocates
 612-987-3297
michael@christophersonadvocates.com